

*We believe in
Trust, Safety & Quality*



SAFETY, DURABILITY & COMFORT



SUPREME ELEVATORS

ISO 9001-2008 Certified Company

Email : supremeelevators6@gmail.com
info@supremeelevators.com

Web: www.supremeelevators.com

About Supreme Elevators

Supreme Elevators is a privately owned full service elevator company providing a full range of elevator services as well as a full line of custom elevators. We are committed to complete customer satisfaction. We have all the facilities to offer tailor-made solutions for our range, as per the specifications of the customers. Besides having good Infrastructure and team, we are recognized for following ethical practices, offering in customized solutions and competitive pricing.

Over View of Products

Design for convenient & comfortable travel, which would be the architectural highlight in a building.

Capsule Elevators, Goods Elevators, Hospital Elevators, Bungalow Elevators, Machine Roomless Elevators, Residential Elevators, Service Elevators, Dumbwaiters, Escalators & Moving Walks, Car Elevators, Gearless Elevators, Duplex Car Parking System, Multi Level Automatic Car Parking System.

ISO 9001 : 2008 Certificate



Authorised by Government of Karnataka



Registration No: MLS / LEP (EM) / 023

Associated with





SUPREME ELEVATORS
ISO 9001:2008 Certified Company

Car & Landing Operating Panel

Soft micro push buttons for operational convenience, easy to read. The digital display with call register and floor position and direction indicator fixed on a stainless steel face plate.



BCK131

Product Features

Ultra slim (9.9mm) surface mounted landing operation panel AISI 304 grade stainless steel body. AISI 430 grade mounting plate Poly carbonate indicator lens, polyamide 6 push button body, SMD production Multicolor 7 segment indicator, overload, busy, out of service icons



False Ceiling

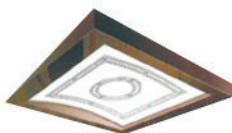

SEF - 2401

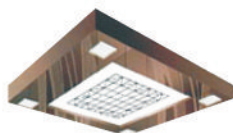

SEF - 2402



SEF - 2403

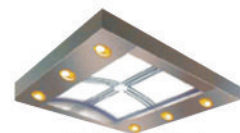

SEF - 2404



SEF - 2405



SEF - 2406

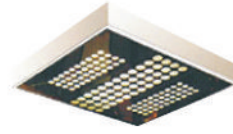

SEF - 2407



SEF - 2408



SEF - 2409



SEF - 2410

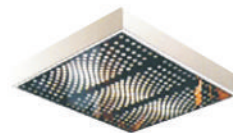

SEF - 2411

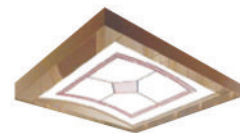

SEF - 2412

Standard Cabins & Options (Stainless Steel 304 Grade)

With our highly specialized knowledge and Vast Experience we provide our clients with the most qualitative range of Stainless Steel Lift Cabins.

Specifications of the Car

Ceiling panel	Mirror finish stainless steel
Side panel	Hairline finish steel panel
Car door	Mirror etching finish stainless steel
Entrance column	Hairline finish stainless steel
Car operation panel	Hairline finish stainless steel (Installed the side panel)
Sill	Hardened aluminum



Specifications of the Car

Ceiling panel	Gold Hairline finish stainless steel
Side panel	Gold Hairline+Gold Etching finish steel panel
Car door	Gold Etching finish stainless steel
Entrance column	Gold Hairline finish stainless steel
Car operation panel	Hairline finish stainless steel (Installed the side panel)
Sill	Hardened aluminum

Specifications of the Car

Ceiling panel	Hairline finish stainless steel
Side panel	Hairline finish steel panel
Car door	Finish stainless steel
Entrance column	Hairline finish stainless steel
Car operation panel	Hairline finish stainless steel (Installed the side panel)
Sill	Hardened aluminum



Landing Door Panels (Stainless Steel 304 Grade)



SS Center Opening Automatic Door



SS Telescopic Opening Automatic Door



SS Gold Etching Center Opening Automatic Door



SS Glass Automatic Door

MS Powder Coated Cabins

Specifications of the Car

Ceiling Panel	MSPC Panel
Side Panel	Hairline finish steel panel
Car Door	MSPC Center Open Door
Car Operation Panel	Hairline finish stainless steel
Sill	Hardened aluminum

OPTIONAL



Specifications of the Car

Ceiling Panel	MSPC finish steel
Side Panel	MSPC finish steel panel
Car Door	MSPC finish steel
Entrance Column	MSPC finish steel
Car Operation Panel	Hairline finish stainless steel
Sill	Hardened aluminum

Specifications of the Car

Ceiling	Acrylic blocks and milky white resin board
Walls	Powder coated steel sheet
Transom Panel	Powder coated steel sheet
Doors	Powder coated steel sheet
Front Return Panels	Stainless steel hairline
Flooring	Durable vinyl tiles
Car Operating Panel	Stainless steel hairline
Sill	Hardened aluminum



MS Powder Coated Door

We offer our clients a wide variety of Lift Doors Frames which are manufactured by a Premium Quality Material to ensure high durability and Efficient Performance.



MS Center Opening Automatic Door



MS Center Opening Automatic Door



MS Telescopic Automatic Door



MS Semi Automatic Door

Hospital Lift

We offer Hospital Lifts for Hospitals for easy transportation of bulky equipments as well as patients. These are apt to meet the modern day hospital needs. These have sophisticated looks with high functionality. Hospital Lifts are best to carry gurneys, stretchers as well as wheel chairs. We offer these at attractive prices and in various models.



Home Lift



Goods Lift

Panaromic Elevators



Escalator

Escalator Civil Dimension

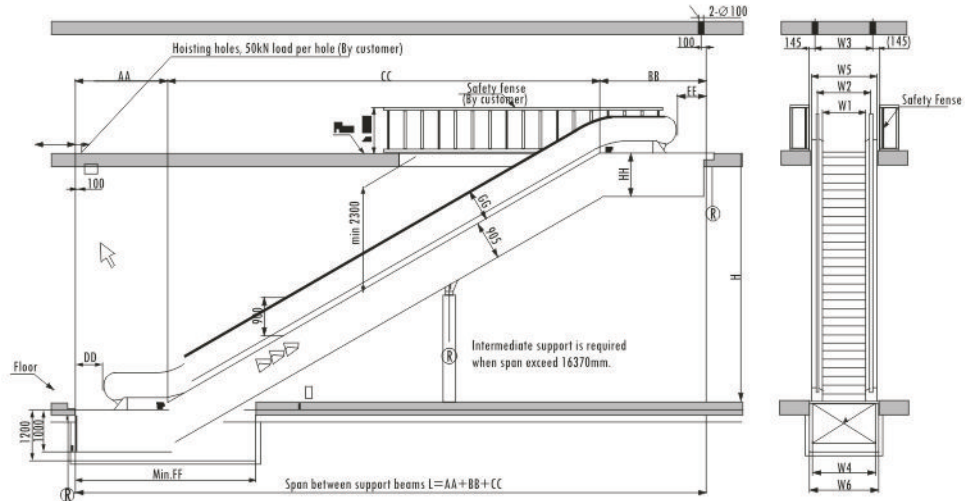

Escalator Mounting Detail

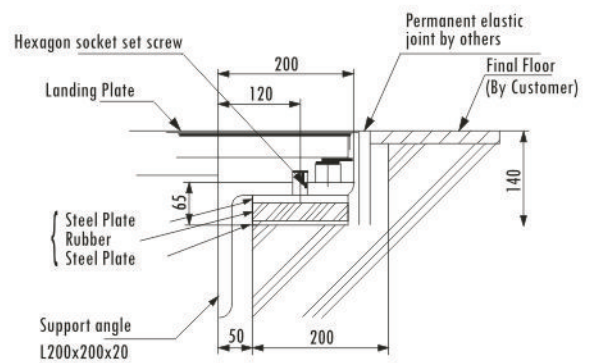

Type	Step Width	AA	BB	CC	DD	EE	FF	GG	HH
30-2	1000/800	2215	2500	1.7321H	667	667	4285	780	1000
	600	2215	3000	1.7321H	667	1167	4285	780	1000
35-2	1000/800	2250	2560	1.4281H	667	667	4080	737	1000
	600	2250	3060	1.4281H	667	1167	4080	737	1000
30-3	1000/800	2615	3034	1.7321H	667	667	4285	780	1300
	600	2615	3534	1.7321H	667	1167	4285	780	1300
35-3	1000/800	2650	2960	1.4281H	667	667	4080	737	1000
	600	2650	3460	1.4281H	667	1167	4080	737	1000

Supreme Advanced Technology Control Systems

Automatic Rescue Device (ARD)

FEATURES:

In case of a main power supply failure or the lift stopped between two floors is moved to ground floor level, the automatic door is opened and passengers are landed safely for lifts with automatic door, in case of a main power supply failure at ground floor level, the door remain opened.



Elevator Control Panel

Controller Imported Version Microprocessor Based V3F Controller
Smooth Start & Smooth stop programmable according to customer requirements & easy Maintenance with power saving features.



AC VVVF Drives

- ▣ Power Saving Features
- ▣ Range upto 37 kw
- ▣ Built-in Breaking Circuit
- ▣ High Overload Capacity
- ▣ Automating without deroping
- ▣ High Performance without load cell
- ▣ 48vdc battery operation



**High Performance
Integrated Controller
for Elevators**



MRL Panel

Traction Machine

Max. Static Load : 3050 Kg
Brake : DC110V, 1.0 A
Weight : 240 Kg

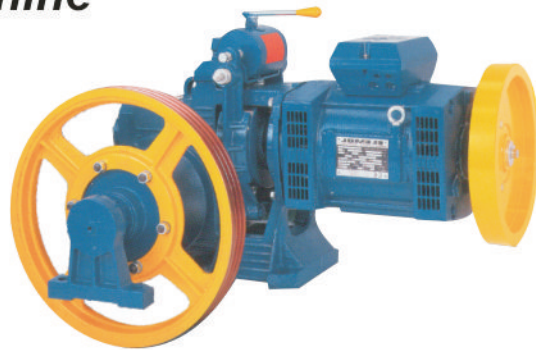

Gear for capacities up to 408 kg.
Static load 3.200 kg.

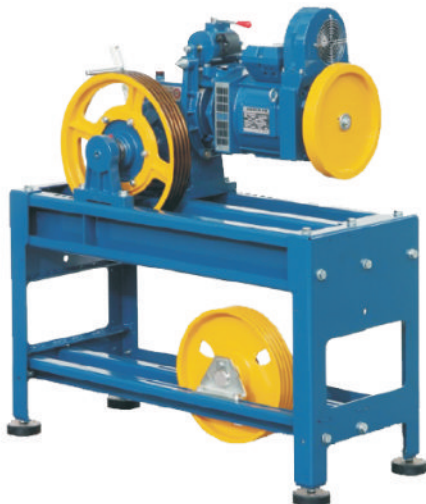

Voltage : 380V
Suspension : 2:1
Brake: DC110V 3.2A
Weight : 418 kg
Max. Static Load : 4000kg
Load : 630 - 1500kg
Speed : 0.5-2.0 m/s



Max. Static Load : 4150 Kg
Brake : DC110V, 1.0 A
Weight : 320 Kg



Overspeed Governor
Tenditori Tension Device
From 0, 15 to 4 m/sec.



SUPREME ELEVATORS
ISO 9001:2008 Certified Company

Door Mechanisms

German make car door Operator & Landing Door Mechanism

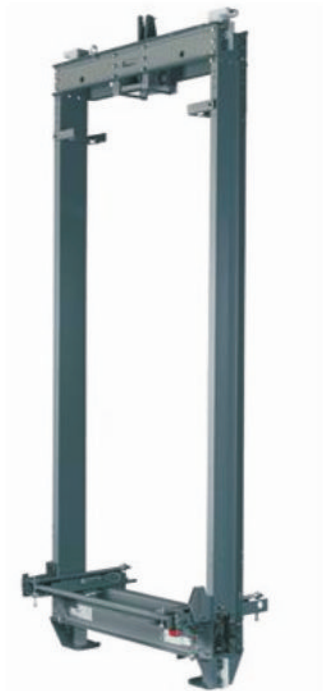
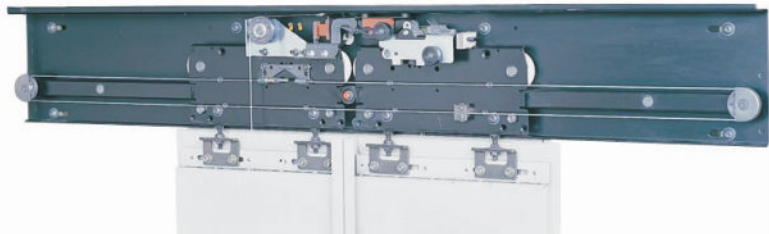

Car Frame

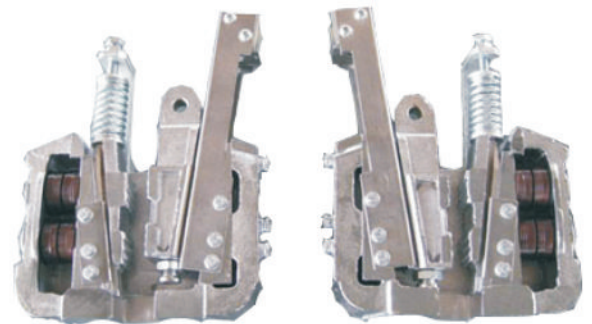

Safety Gears



MS Imperforated Door



Usha Martin Rope

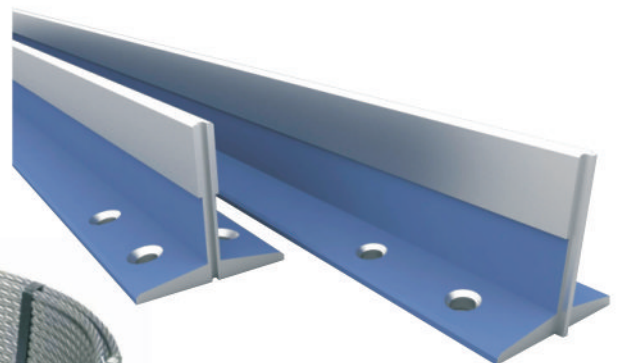

Imported Guide Rails



SUPREME ELEVATORS
ISO 9001:2008 Certified Company

Specifications

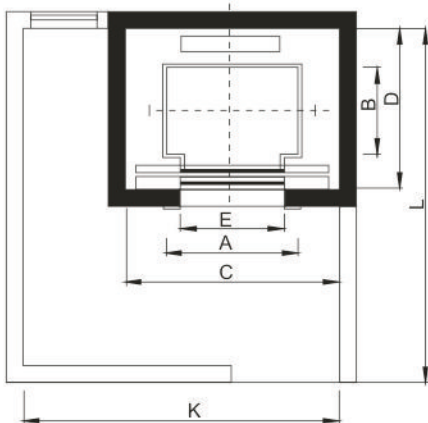

MACHINE ROOM & HOISTWAY PLAN

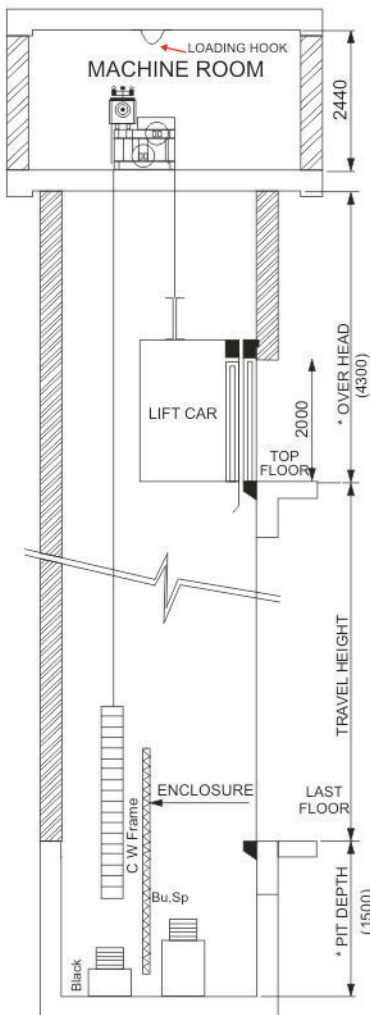

(SECTION : X-X) LIFT WELL

NOTES

- Machine room height is as follows
 - For passenger elevators = 2500
 - For Hospital and freight elevators = 2300
 - For Dumbwaiters = 1200
- All Hoistway wall should be minimum 230 brick or 150 RCC.
- All dimensions are in millimeters.

PASSENGER ELEVATORS

LOAD		CAR INSIDE		ELEVATOR WELL		ENT	MACHINE ROOM			TYPE OF DOOR
PERSONS	KG	WIDTH A	DEPTH B	WIDTH C	DEPTH D	E	WIDTH K	DEPTH L	HIGHT H	
4	272	1100	700	1600	1100	700	3100	3600	2500	MANUAL
5	340	1100	850	1600	1300	700	3100	3600	2500	
6	408	1100	1000	1600	1400	800	3100	3900	2500	
8	544	1300	1100	1800	1550	800	3300	4050	2500	
4	272	1100	700	1600	1400	700	3490	3600	2500	AUTOMATIC
5	340	1100	850	1600	1500	700	3100	3600	2500	
6	408	1100	1000	1600	1600	700	3400	4100	2500	
8	544	1300	1100	1800	1700	800	3400	4400	2500	
10	680	1350	1300	1900	2000	800	3400	4600	2500	
13	884	2000	1100	2500	1900	900	4000	4400	2500	
16	1088	2000	1300	2500	2100	1000	4000	4600	2500	
20	1360	2000	1550	2500	2400	1000	4000	4900	2500	
24	1632	2150	1650	2650	2500	1100	4150	4950	2500	

HOSPITAL ELEVATORS

LOAD		CAR INSIDE		ELEVATOR WELL		ENT	MACHINE ROOM	
PERSONS	KG	WIDTH A	DEPTH B	WIDTH C	DEPTH D	E	WIDTH K	DEPTH L
15	1020	950	2400	1700	3000	800	3700	5500
20	1360	1300	2400	2200	3000	1200	4200	5500
26	1768	1600	2400	2350	3000	1200	4350	5500

SPEED (MPS)	PIT DEPTH	OVER HEAD
UPTO-1.50	1600	4800
OVER 1.50 UP TO 2.5	2600	5700
OVER 2.5	2600	6700

DUMB WAITERS

LOAD	CAR SPEED		CAR INSIDE		ELEVATOR WELL		ENT	MACHINE ROOM	
KG	MPS	WIDTH A	DEPTH B	HIEGHT H	WIDTH C	DEPTH D	E	WIDTH K	DEPTH L
100	0.50	700	700	800	1200	1000	700	1400	1500
150	0.50	800	800	900	1300	1200	800	1500	1500
200	0.25	900	900	1000	1400	1200	900	1500	1800
250	0.70	1000	1000	1200	1500	1300	1000	1800	2000

FREIGHT ELEVATORS

LOAD	CAR INSIDE		ELEVATOR WELL		ENTRANCE	MACHINE ROOM	
KG	WIDTH A	DEPTH B	WIDTH C	DEPTH D	E	WIDTH K	DEPTH L
500	1500	1500	2000	2000	900	2500	4500
1000	1400	1800	2300	2100	1400	2500	4600
1500	1700	2000	2600	2300	1700	2600	4800
2000	1700	2500	2600	2800	1700	2600	5300
3000	2000	3000	2900	3300	2000	2900	5800
4000	2500	3000	3400	3300	2500	3400	5800
5000	2500	3600	3400	3900	2500	3400	6400

Clear entrance width is based on vertical lifting car door and vertical bi-parting landing doors. For collapsible mid bar doors the clear entrance width will be reduced by 2000 mm (max. 1200 mm).

Recommended Dimensions of MRL Lifts (Machine Room Less)

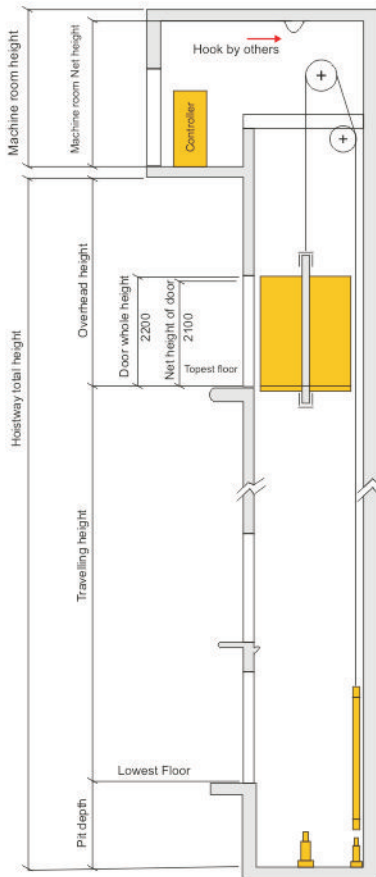

(SECTION : X-X) LIFT WELL

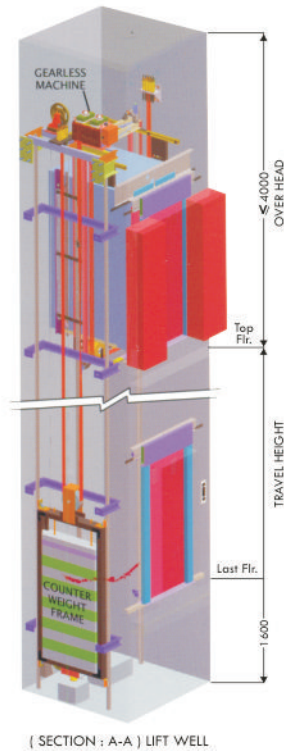

(SECTION : A-A) LIFT WELL

Automatic Centre Opening / Telescopic Doors-MRL Lifts

No. of Persons	Rated Capacity	Entrance Width	Car Size	Lift Shaft
	KG	E	A X B	C X D
6	408	700	1100 X 1000	1850 X 1400
8	544	800	1100 X 1300	1950 X 1700
10	680	800	1300 X 1350	2050 X 1750
13	884	900	1300 X 1700	2100 X 2100
16	1088	1000	1500 X 1750	2350 X 2150
20	1360	1000	1500 X 2000	2350 X 2400

Hydraulic Lifts Civil Dimension

Persons	Capacity Kg	Car-w (A)	Car-d (B)	Shaft-w (C)	Shaft-d (D)
3	225	800	900	1300	1300
4	300	850	1050	1350	1450
5	375	1000	1200	1500	1500
6	450	1100	1250	1600	1600

Recommended Dimensions of Capsule Autodoor Lifts

Option - A

Load		Car Inside				Lift Well				Entrance
Persons	kg	A	B	J	G	C	D	F	H	E
8	544	1000	1200	1250	600	2000	1225	1235	1000	800
10	680	1100	1300	1400	650	2200	1325	1330	1100	900
13	884	1200	1400	1550	700	2400	1425	1430	1100	1000
16	1068	1300	1500	1700	750	2800	1525	1530	1200	1200

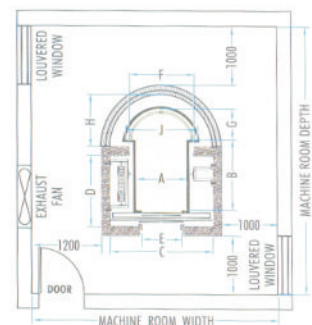

Option - B

Load		Car Inside			Lift Well			Entrance
Persons	kg	A	B	G	C	D	H	E
6	408	1000	1100	200	1850	1250	470	800
8	544	1150	1200	200	2050	1350	520	900
10	680	1250	1300	250	2250	1450	590	1000
13	884	1400	1400	300	2400	1550	650	1200
16	1068	1550	1500	350	2800	1650	790	1200

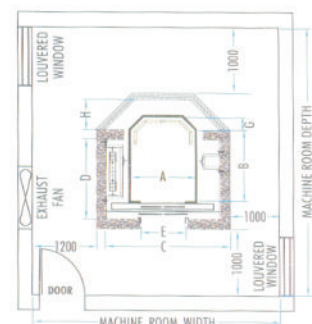

Powder Coat - Colours

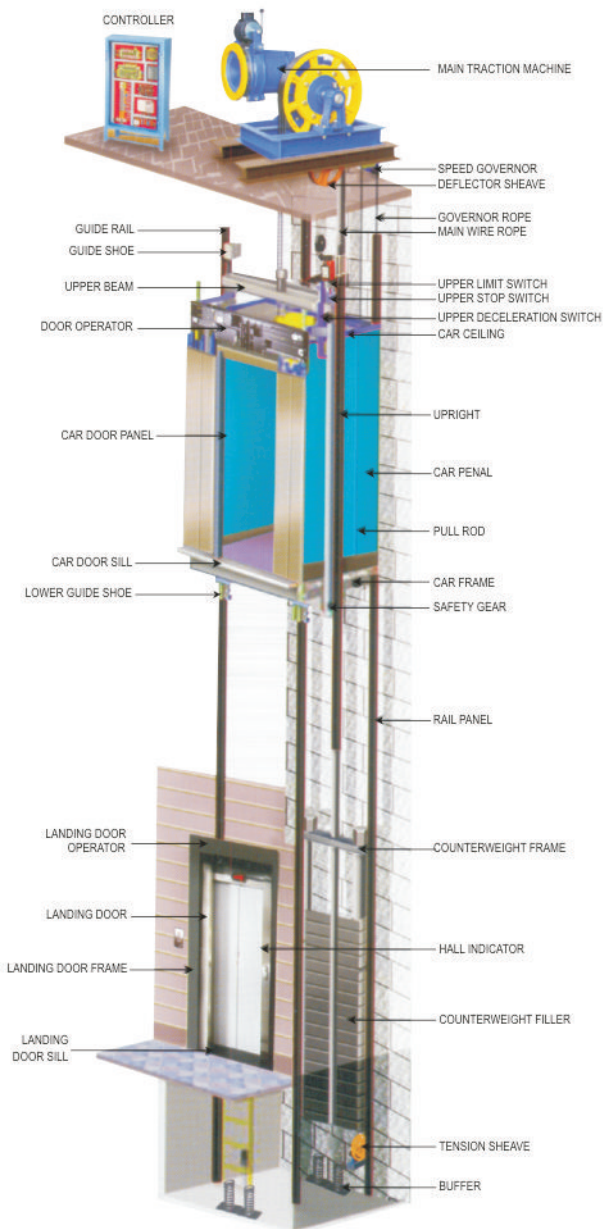

		
1 Oxford Blue Glossy	2 Classic White	3 Milky White
		
4 Cherry / Wine Red	5 Golden Yellow	6 Pink Glossy
		
7 Steel Gray Satin	8 Ivory Glossy	9 Brilliant Green Glossy
		
10 Orange Glossy	11 PO Red Glossy	12 Rubine Pink Glossy
		
13 New Moon Glossy	14 Light Blue Glossy	15 Deep Blue Glossy



SUPREME ELEVATORS

ISO 9001-2008 Certified Company



SUPREME ELEVATORS

ISO 9001-2008 Certified Company

Office:

86, 1st Main, Venkateshwara Layout,
BCC Layout, Vijayanagar,
Bangalore - 560 040

Mob: 9620751251, 8296032649, 8296032661

Branch:

7, Opp. BHEL Factory, Mysore Road,
Above SBM, Bangalore-560 026.

Mob: 9620751251, 8296032649, 8296032661

Email: supremeelevators6@gmail.com
info@supremeelevators.com
sales@supremeelevators.com

Web: www.supremeelevators.com